

# Complete line: drying and curing solvent-based coating on aluminium plate



**Manufactured in:** 2017  
**Place:** Germany



### Complete line

#### Dimensions:

Length: 35 000 mm  
Width: 6 000 mm  
Height: 5 000 mm

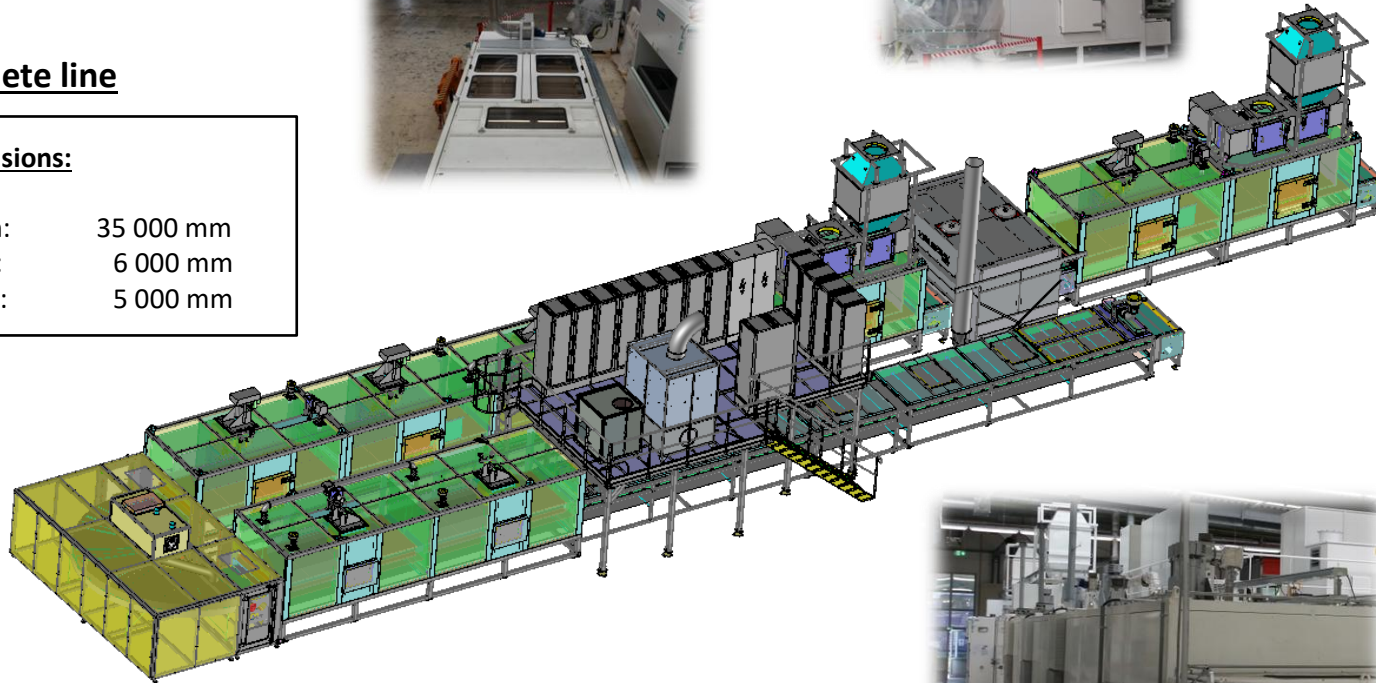

#### **Technical data:**

- Gas
- Working temperature: 80-250 °C
- Maximum temperature: 300 °C
- Insulating capacity: +/- 5 °C



### Services supplied:

- Study and design
- Assembly and wiring
- Starting up and tests
- Delivery
- On site:
- Assembly, starting up, test
- Training

### NOT included :

- Civil engineering
- Supply and installation air intake and extraction pipes
- Connection to local energy network (current, air, ...)